

Straight-Line high quality emergency exit luminaires, made of powder coated aluminium profile of just 14.5mm thickness without any visible screws. Slim design and brilliant illumination by cutting-edge fibre optics technology with a luminance of > 500cd/m².

Technical data

- Viewing distance :** 30 m
 - Material :** Aluminum powder-coated
 - Illuminant :** LEDs
 - Nominal voltage DC :** 24V ± 20%
 - Nominal current :** 180 mA
 - Terminals :** 2.5 mm² for feed-through wiring
 - Temperature ta :** -15°C... +40°C
 - Protection category :** IP40
 - Protection class :** III
- acc. to DIN EN 60598-1, DIN EN 60598-2-22, DIN 4844-1 and DIN EN 1838

Pictograms exchangeable without tools

Housing-colours	Part.no.	Colour code
White (RAL 9016)	...	L04
Dark grey (RAL 7015)	...	L16
Special colours	...	L99
Attach the colour code to part number e.g.	800 014	LXX

SNP 1530 D LED 24V

Art.no. 810 145

Ceiling mounting

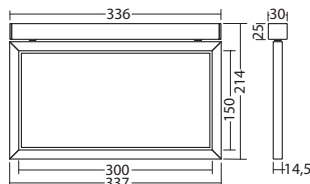

SNP 1530 P LED 24V

Art.no. 810 147

Pendulum mounting

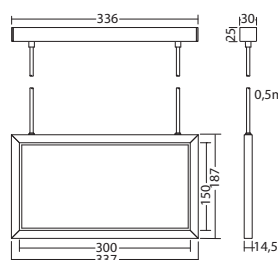

SNP 1530 S LED 24V

Art.no. 810 146

Cable suspension mounting

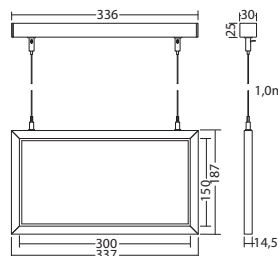

SNP 1530 E LED 24V

Art.no. 810 178

Recessed ceiling mounting

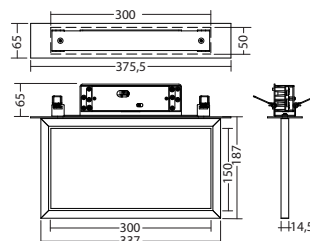

Straight-Line high quality emergency exit luminaires, made of powder coated aluminium profile of just 14.5mm thickness without any visible screws. Slim design and brilliant illumination by cutting-edge fibre optics technology with a luminance of > 500cd/m².

Technical data

- Viewing distance :** 30 m
Material : Aluminum powder-coated
Illuminant : LEDs
Nominal voltage DC : 24V ± 20%
Nominal current : 100 mA
Terminals : 2.5 mm² for feed-through wiring
Temperature ta : -15°C... +40°C
Protection category : IP40
Protection class : III
 acc. to DIN EN 60598-1, DIN EN 60598-2-22, DIN 4844-1 and DIN EN 1838

Pictograms exchangeable without tools

Housing-colours	Part.no.	Colour code
White (RAL 9016)	...	L04
Dark grey (RAL 7015)	...	L16
Special colours	...	L99

Attach the colour code to part number e.g. **800 014 LXX**

SNP 1530 PM LED 24V

Art.no. 810 144

Parallel to wall mounting

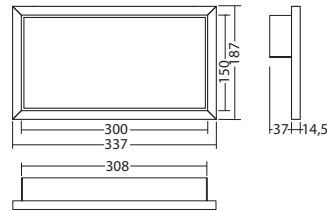

SNP 1530 WE LED 24V

Art.no. 810 148

Recessed wall mounting

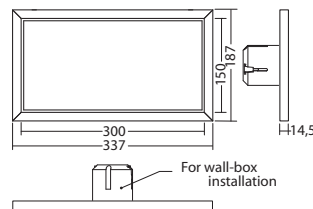

Supply unit SNP 1520/1530 WE

Art.no. 890 434

Accessory

