

Straight-Line high quality emergency exit luminaires, made of powder coated aluminium profile of just 14.5mm thickness without any visible screws. Slim design and brilliant illumination by cutting-edge fibre optics technology with a luminance of > 500cd/m<sup>2</sup>.

**Technical data**

- Viewing distance :** 30 m
- Material :** Aluminum powder-coated
- Illuminant :** LEDs
- Nominal voltage AC :** 230V ± 10%, 50/60Hz
- Nominal voltage DC :** 220V ± 20%
- Nominal current :** 32 mA
- Power consumption :** 9.2 VA
- Terminals :** 2.5 mm<sup>2</sup> for feed-through wiring
- Temperature ta :** -15°C... +40°C
- Protection category :** IP40
- Protection class :** I

acc. to DIN EN 60598-1, DIN EN 60598-2-22, DIN 4844-1 and DIN EN 1838

**Pictograms exchangeable without tools**

Housing-colours	Part.no.	Colour code
White (RAL 9016)	...	L04
Dark grey (RAL 7015)	...	L16
Special colours	...	L99

Attach the colour code to part number e.g. **800 014 LXX**

**SNP 1530 D LED 230V**

Ceiling mounting

Art-no.801 286 - J/SV  
Art-no.801 311 - SKÜ  
Art-no.801 316 - NE/SV

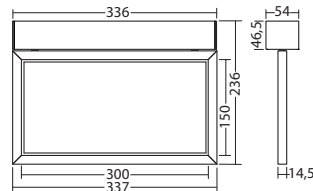

**SNP 1530 P LED 230V**

Pendulum mounting

Art-no.801 288 - J/SV  
Art-no.801 313 - SKÜ  
Art-no.801 318 - NE/SV

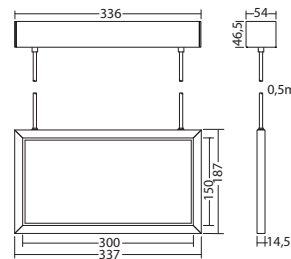

**SNP 1530 S LED 230V**

Cable suspension mounting

Art-no.801 287 - J/SV  
Art-no.801 312 - SKÜ  
Art-no.801 317 - NE/SV

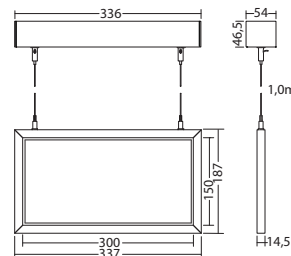

**SNP 1530 E LED 230V**

Recessed ceiling mounting

Art.no.801 344 - J/SV  
Art.no.801 343 - SKÜ  
Art.no.801 345 - NE/SV

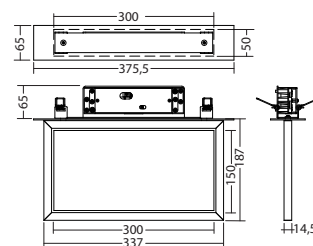

Straight-Line high quality emergency exit luminaires, made of powder coated aluminium profile of just 14.5mm thickness without any visible screws. Slim design and brilliant illumination by cutting-edge fibre optics technology with a luminance of > 500cd/m².

**Technical data**

- Viewing distance :** 30 m
- Material :** Aluminum powder-coated
- Illuminant :** LEDs
- Nominal voltage AC :** 230V ± 10%, 50/60Hz
- Nominal voltage DC :** 220V ± 20%
- Nominal current :** 18 mA
- Power consumption :** 6.4 VA
- Terminals :** 2.5 mm² for feed-through wiring
- Temperature ta :** -15°C... +40°C
- Protection category :** IP40
- Protection class :** I

acc. to DIN EN 60598-1, DIN EN 60598-2-22, DIN 4844-1 and DIN EN 1838

**Pictograms exchangeable without tools**

Housing-colours	Part.no.	Colour code
White (RAL 9016)	...	L04
Dark grey (RAL 7015)	...	L16
Special colours	...	L99

Attach the colour code to part number e.g.

**800 014 LXX**

**SNP 1530 PM LED 230V**

Parallel to wall mounting

- Art.no. 801 285 - J/SV
- Art.no. 801 310 - SKÜ
- Art.no. 801 315 - NE/SV

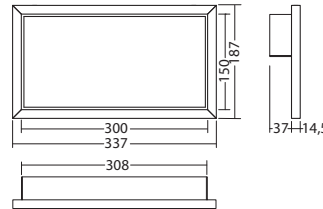

**SNP 1530 WE LED 230V**

Recessed wall mounting

- Art.no. 801 314

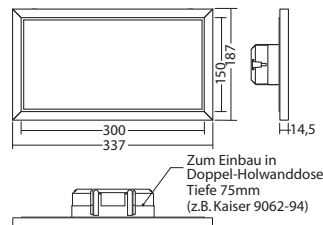

**Supply unit SNP 1520/1530 WE**

Accessory

- Art. no. 890 435 - J/SV
- Art. no. 890 436 - SKÜ
- Art. no. 890 437 - NE/SV

